

## PL Markings Required by IBC in Egress Stairwell

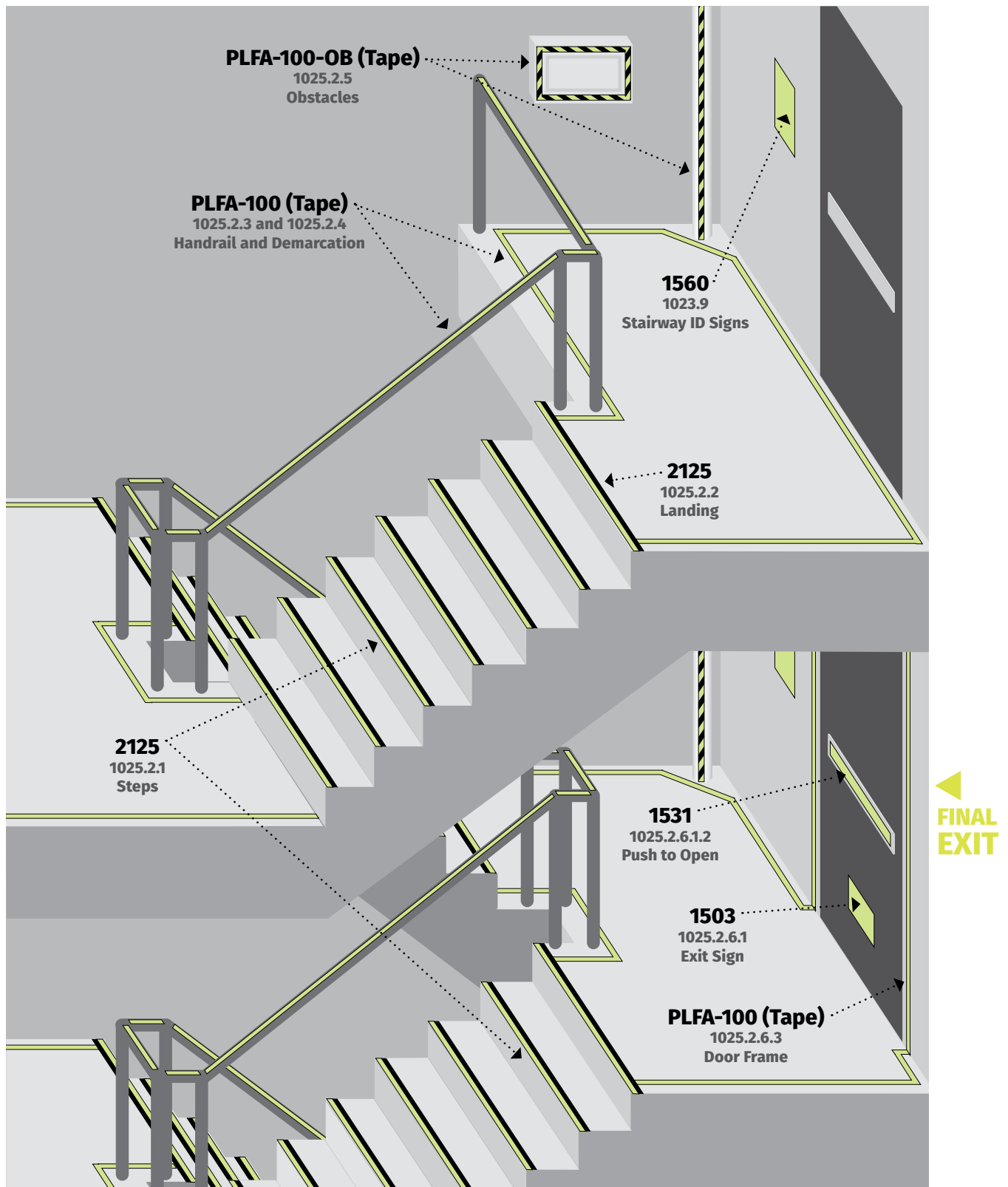

# ***IllumiTread™***

Photoluminescent Egress Solutions

[balco.us/pl](http://balco.us/pl) [balco.us/illumitread](http://balco.us/illumitread)



**2021 IBC  
Stairwell**

Balco, Inc. Wichita, Kansas 67219 316.945.9328 | 800.767.0082 [balcousa.com](http://balcousa.com)

Balco, the logos and other trademarks are property of Balco, Inc., its affiliates or its licensors and are protected by copyright, trademark and other intellectual property laws, and may not be used without permission. Balco, Inc. reserves the right to change specifications without prior notice.

©2024 Balco, Inc. All rights reserved. B50171-1123